

MINED LAND

Story of environmental devastation and successful habitat restoration, the Mined Land Wildlife Area (MLWA) is located in Crawford, Cherokee, and Labette counties in southeast Kansas. Mining in the area began

in the late 1800s. Big Brutus, a twelve million pound electric coal shovel, remains near MLWA #44 as a reminder. Today, the area is characterized by woodlands, healthy grasslands, and abundant water.

The first land donation was

received in 1926. The largest acquisition, totalling 8,208 acres, was donated by the Pittsburg and Midway Coal Company to the Kansas Department of Wildlife and Parks in 1981. The area includes 46 tracts totalling 14,500 acres.

FISHING

Several hundred water-filled pits dot the MLWA, creating about 1,500 acres of public waters. More than 200 lakes on the area are managed for fishing.

Strip-mine lakes produce some of Kansas' finest fishing. Sportfish include largemouth bass, rainbow trout, walleye, channel catfish, crappie, bluegill, redear sunfish, spotted bass, wipers, bullhead, and warmouth. Some lakes have been specially managed to favor certain fish species.

Special length and creel limits may be in effect for some fish species. Check the Kansas Fishing Regulations Summary and all posted notices before

fishing. The trout lake, a 28-acre strip-mine lake located within unit 30 is stocked with rainbow and brown trout. Unique water characteristics allow the trout to survive and grow year-round. A trout stamp is required for anyone age 16 or older to fish the trout lake.

Most MLWA waters are quite clear, and fishing is challenging. Anglers who approach the water quietly, use light line and fish during low-light hours are more successful. Boats help reach many of the prime fishing spots. The lakes are mostly sheltered from wind and too small for large craft. Small boats and float tubes work best.

Waterfowl hunting can also be good on the area. Several marshes have been constructed to attract ducks. A waterfowl refuge often holds several hundred Canada geese in the area.

The woodlands areas of the property hold good populations of white-tailed deer and eastern turkey.

The area supports good numbers of raccoons, muskrats, bobcats, beavers, and coyotes. Other furbearers, including mink, and fox are also common.

alternative to tent and RV camping. The cabins are located on Unit 30 of the wildlife area overlooking the Trout Lake. The cabins are named Coal Ridge (west) and Mine 19 (east) to represent the coal mining era that once dominated this landscape. The cabins are available for rent year-round and will accommodate up to six overnight guests. For reservations go to: www.reserve.ksoutdoors.com

THINGS TO REMEMBER

Vehicles are restricted to maintained roads and parking areas. Some roads are closed to all traffic. Do not leave vehicles parked on boat ramps. Use caution when launching boats because ramps drop off sharply, and trailers backed too far may become high-centered. Boat ramps are available on most large lakes.

Swimming is NOT allowed on the area.

Many of the lakes are steep sided, Anglers wading the shorelines should use caution.

Tent camping is allowed at any location except refuge areas. RVs may be parked in designated areas or parking lots. RVs may not block boat ramps, restrict road traffic, or drive off roads. No hookups are available.

Visitors must take their trash with them. Check the Kansas Fishing Regulations Summary and all posted notices before fishing.

Certain areas may be closed to hunting and fishing periodically.

Target shooting, trotlines and setlines are prohibited on all areas.

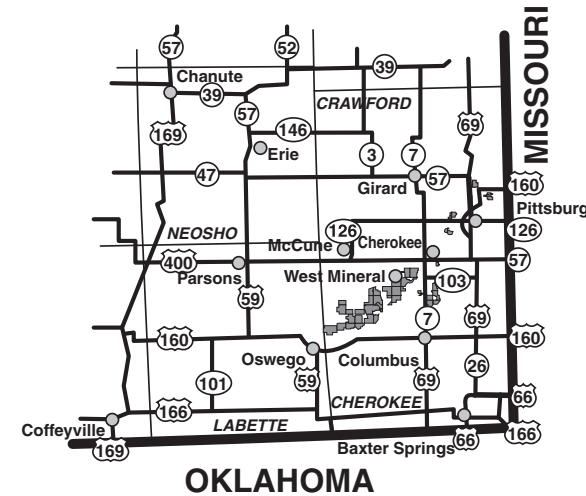

General Area Map

Equal opportunity to participate in and benefit from programs described herein is available to all individuals without regard to race, color, national origin, sex, age, disability, sexual orientation, gender identity, political affiliation, and military or veteran status. Complaints of discrimination should be sent to Office of the Secretary, Kansas Department of Wildlife and Parks, 1020 S Kansas Ave., Topeka, KS 66612-1327. 10/10

Mined Land Wildlife Area

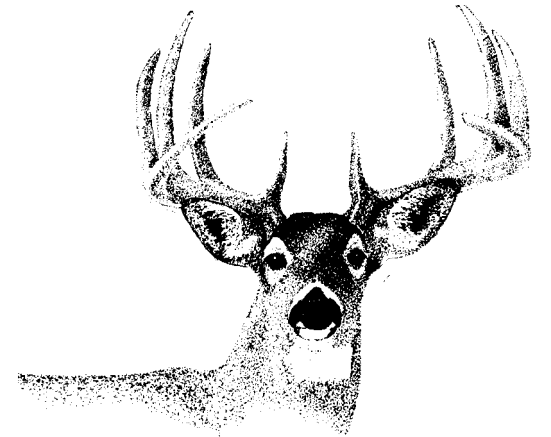

Mined Land Wildlife Area
507 E 560th Ave.
Pittsburg, KS 66762
(620) 231-3173 (Area Office)
(620) 827-6301 (Field Office)
(620) 431-0380 (Regional Office)

Department Website:
kdwp.state.ks.us

MINED LAND WILDLIFE AREA (SCAMMON UNITS)

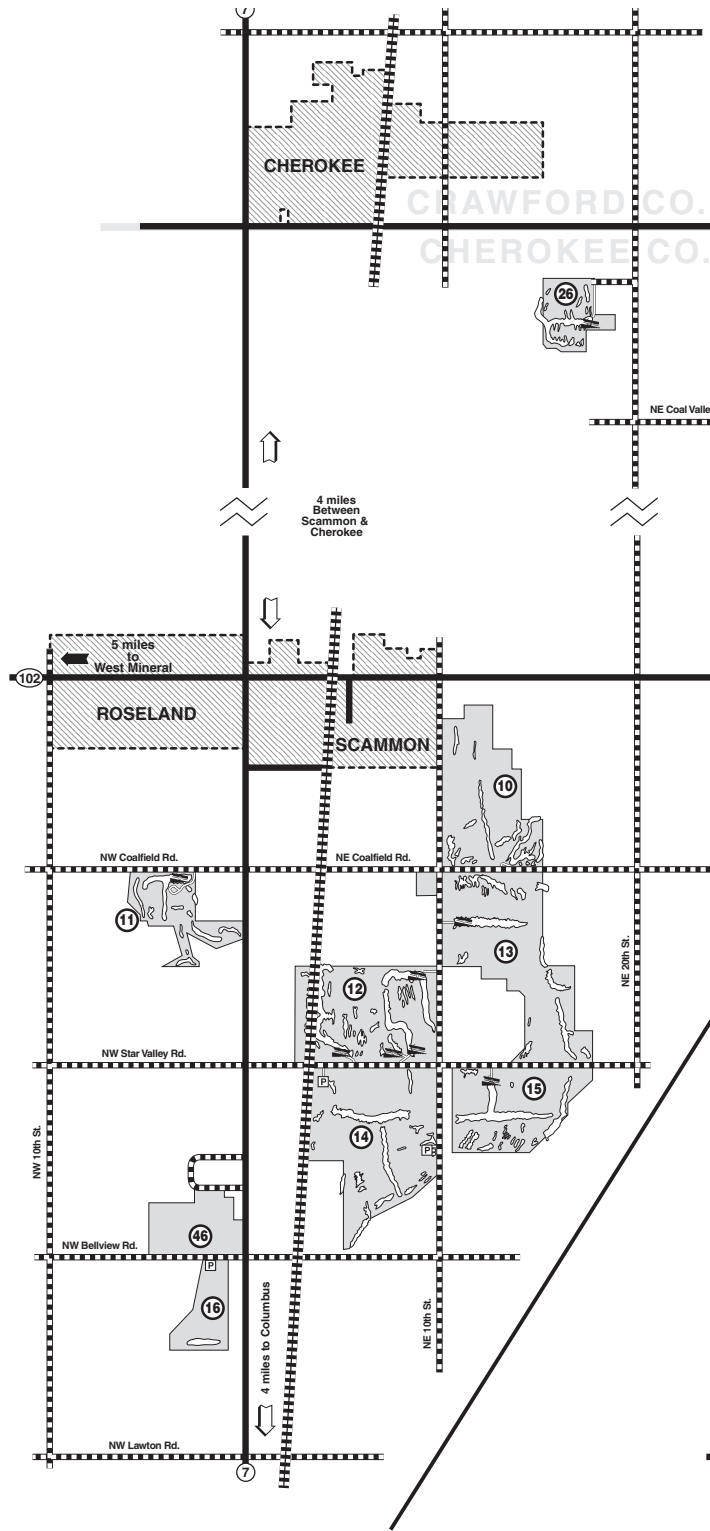

MINED LAND WILDLIFE AREA (PITTSBURG UNITS) Crawford County

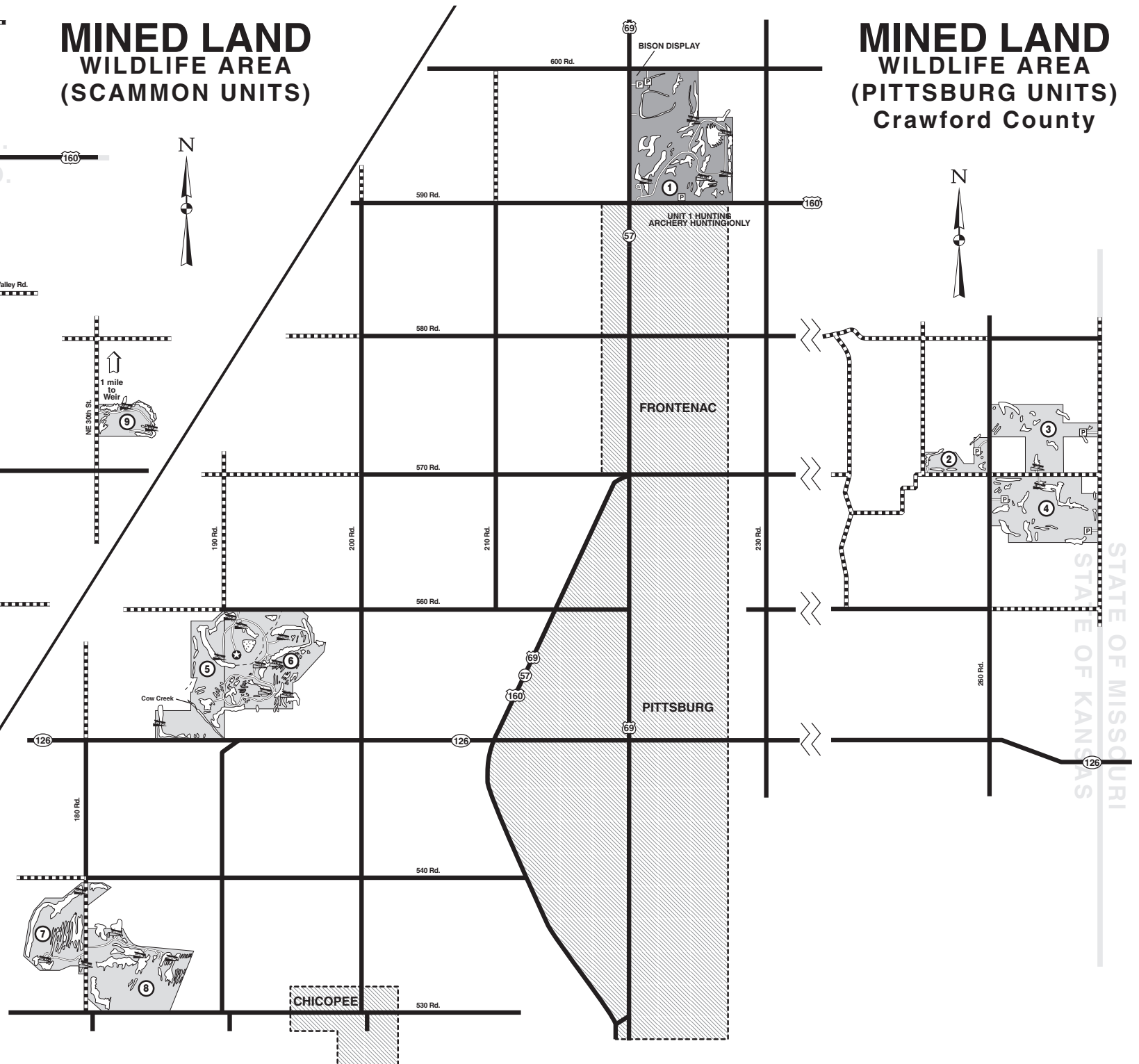

MINED LAND WILDLIFE AREA (WEST MINERAL UNITS)

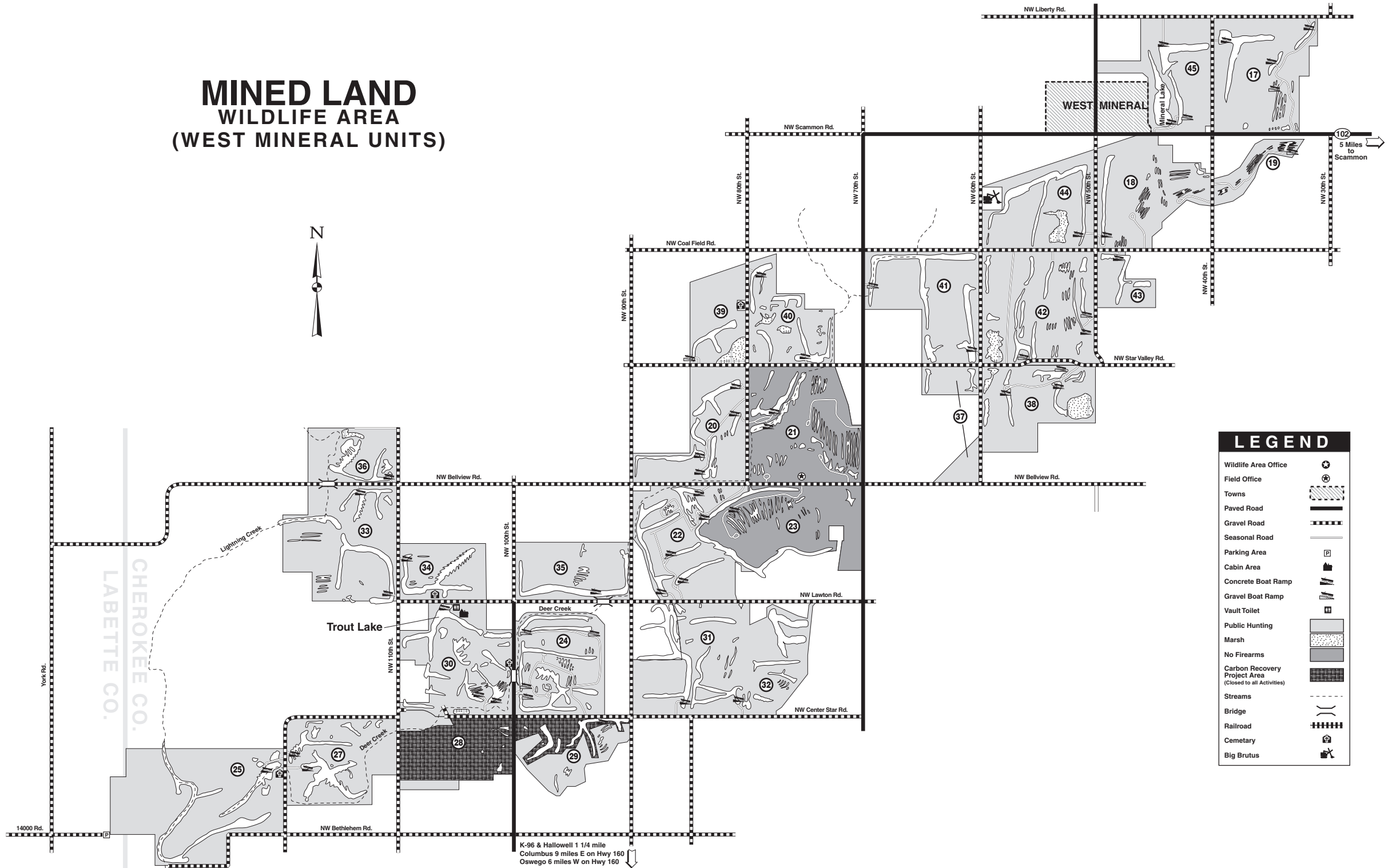

LEGEND

- Wildlife Area Office
- Field Office
- Towns
- Paved Road
- Gravel Road
- Seasonal Road
- Parking Area
- Cabin Area
- Concrete Boat Ramp
- Gravel Boat Ramp
- Vault Toilet
- Public Hunting
- Marsh
- No Firearms
- Carbon Recovery Project Area
(Closed to all Activities)
- Streams
- Bridge
- Railroad
- Cemetary
- Big Brutus

K-96 & Hallowell 1 1/4 mile
Columbus 9 miles E on Hwy 160
Oswego 6 miles W on Hwy 160